

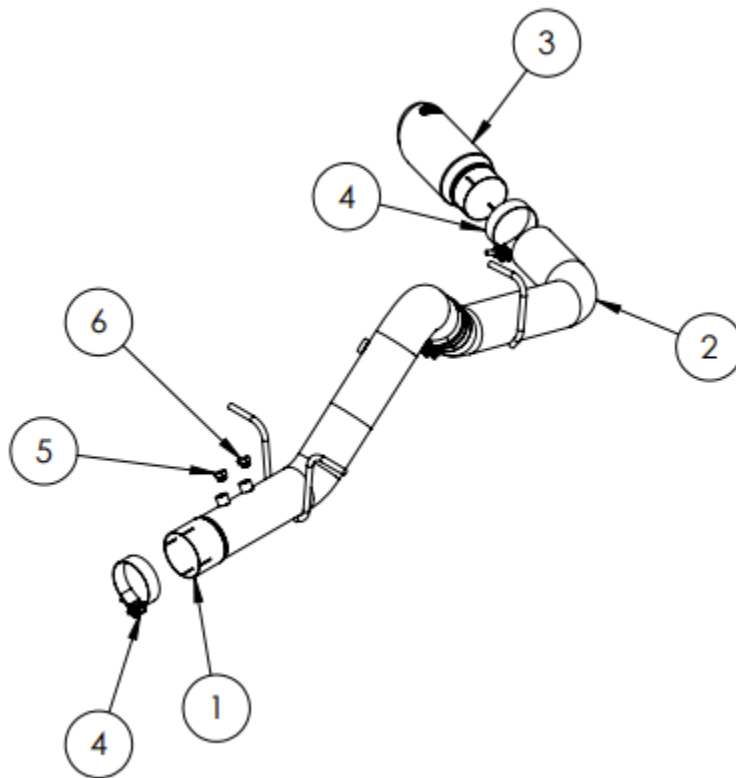

INSTALLATION INSTRUCTIONS:
2020+ CHEVY/GM 2500/3500 2500HD DIESEL TRUCKS
PART # 49861, 19860

Congratulations, you have purchased the finest exhaust tip available for your truck. Your Vance & Hines exhaust tip is designed and crafted for quality, and style. Please follow the instructions below, check exhaust system for missing or damaged parts and if you need any assistance, please contact our technical support line (562) 921-7461.



Item #	PART #	DESCRIPTION	QTY
1	C350RB	GM DPF TAILPIPE A	1
2	C355RB	GM DPF TAILPIPE B	1
3	DT820RM OR DT835RP-S	DIESEL 5" TWIN SLASH TIP OR DIESEL 5" ELIMINATOR TIP	1
4	A986HW	TORCA 4" X 1.25 CLAMP	3
5	A1212HW	M16 PORT PLUG	1
6	A1210HW	M14 PORT PLUG	1



TOOLS REQUIRED:

- 15MM and 16MM DEEP SOCKET
- 24MM NOx & SOOT SOCKET
- 14,15,16,17MM WRENCHES
- MARKER
- SAWZALL
- DEBURR WHEEL / DEBURR KNIFE / SANDPAPER

NOTE:

WHEN INSTALLING A NEW EXHAUST TIP, MAKE SURE YOUR HANDS ARE CLEAN AND FREE OF OIL. AFTER INSTALLATION, THOROUGHLY CLEAN PIPES WITH WARM SOAPY WATER AND A SOFT CLOTH. DRY WITH A CLEAN TOWEL TO REMOVE ANY RESIDUE BEFORE STARTING THE TRUCK. DO NOT USE ANYTHING ABRASIVE TO CLEAN THE PIPES.

STOCK EXHAUST REMOVAL	
STEP 1: Apply lubricant to all exhaust hangers and rubber isolators to aid in removal.	
STEP 2: Standard (Short) Bed Models <ol style="list-style-type: none">Locate Diesel Particulate Sensor & EGT Rear Sensor located on rear section of stock tail pipe. (Fig 1)Follow wires and disconnect from harness. Note: Removing sensors by twisting wire may damage wires and make sensor inoperable.Remove Diesel Particulate Sensor, EGT Rear Sensor and Rear Exhaust Differential Sensor from stock tail pipe. Save for re-use. Note The Exhaust Pressure Differential Sensor Pipe has a hard line that could be kinked and damaged if removed improperly.Exhaust Pressure Differential Sensor Pipe OEM Replacement Part# - 84346524<ol style="list-style-type: none">Crew Cab Standard (Short) Bed (162.5" wheelbase)Double Cab Standard (Short) Bed (149.4" wheelbase)	
STEP 3: Long Bed Models <ol style="list-style-type: none">Locate Diesel Particulate Sensor located on rear section of stock tail pipe. (Fig 1)Follow wires and disconnect from harness. Note: Removing sensor by twisting wire may damage wires and make sensor inoperable.Remove Diesel Particulate Sensor from stock tail pipe. Save for re-use.	

FIG 1:

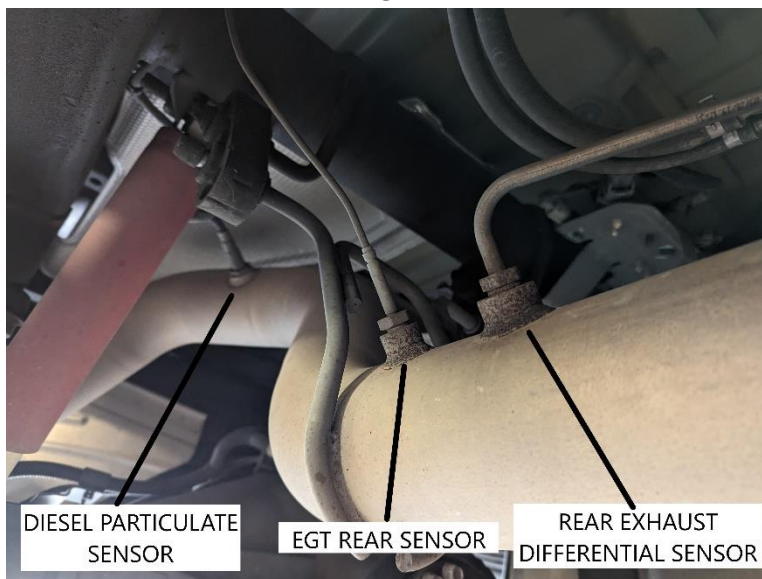

STEP 4:

Locate OEM exhaust hanger forward of the axle and rear of Diesel Particulate Filter (DPF), near the forward leaf spring mount. (Fig 2)

FIG 2:

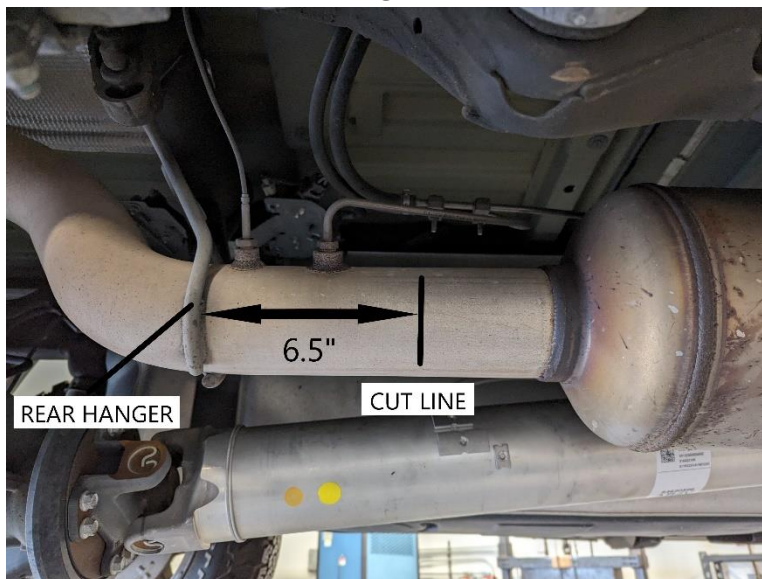

STEP 5:

Measure 6.5 inches forward and scribe a cut line. (Fig 3) Note: Line up Tailpipe A to verify cut line.

FIG 3:

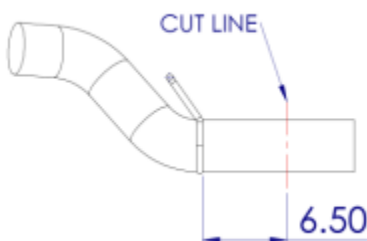

STEP 6:

Cut Stock tailpipe at cutline. Note: Recommend using a deburring tool to clean cut pipe to aid in installation.

STEP 7:

Remove hangers from OEM rubber isolators and carefully remove cut tailpipe from rear of vehicle.

DPF BACK EXHAUST INSTALLATION

STEP 1:

Slide a 4" band clamp over slotted end of Tailpipe A. Note Make sure clamp is orientated so the nut is accessible for tightening.

STEP 2:

Install Tailpipe A on cut end of OEM exhaust and insert hangers into rubber isolators

STEP 3:

Slide a 4" band clamp over slotted end of Tailpipe B. Note Make sure clamp is orientated so the nut is accessible for tightening.

STEP 4:

Install Tailpipe B onto Tailpipe A and insert hangers into rubber isolators

STEP 5:

Slide a 4" band clamp over slotted end of End Tip. Note Make sure clamp is orientated so the nut is accessible for tightening.

STEP 6:

Adjust each of the pipes to ensure that the rubber hangers are all positioned slightly forward. This allows the hangers to be properly positioned once the exhaust system reaches operating temperature. (Fig 4)

FIG 4:



STEP 7:

Adjust End Tip to desired position and tighten tip. (Fig 5)

FIG 5:



STEP 8:

Band Clamp Torque Specification – 45 lb-ft (60 N-m)

STEP 9:

Standard (Short) Bed Models

Re-install Diesel Particulate Sensor, Rear EGT Sensor & Rear Exhaust Differential Sensor. (Fig 6)

FIG 6:

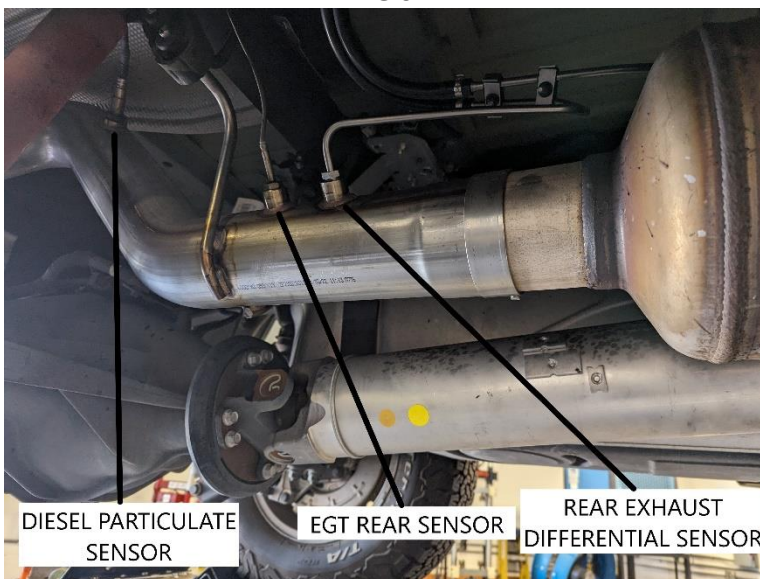

STEP 10:

Long Bed Models

- a. Re-install Diesel Particulate Sensor
- b. Install supplied plugs

STEP 11:

Before start up verify adequate clearance to fuel lines, wires, air lines or any added accessories.
Adjust as needed.

STEP 12:

After installation, thoroughly clean exhaust pipe and tip with warm soapy water and a soft cloth to remove any oils and debris. Dry with a clean towel. Note Do NOT use abrasive cleaners to clean tip as it may stain or damage finish.

STEP 13:

After 50-75 miles of driving re-torque band clamps to 45 lb-ft (60 N-m)